

VANITY

**VANITY
THEATER RENOVATION**



**AN ART CENTER
for the
Community**



**A PROSPECTUS
October 1988**

INTRODUCTION

This prospectus for the Vanity Theater is intended as a guide for the renovation and restoration of the Theater as a permanent home for the Sugar Creek Players and also as a community arts center.

Throughout this prospectus, the renovation implies as many elements of "restoration" of the original theater as feasible to maintain the historic value of the property as well as to enhance aspects of nostalgia.

On Wednesday, December 14, 1983, co-owners, Myron T. Pattison and W. Addington Vance, formally donated the Vanity Theater at 122 South Washington Street, Crawfordsville, Indiana to the Sugar Creek Players who accepted it as their permanent home.

Used as a movie theater from 1935 to 1953, the Vanity had a seating capacity of 500 with admission prices of 10 and 20 cents. In the 1940's, cowboy films were the regular fare with serials shown each Saturday afternoon. Since the Vanity Theater closed its doors in 1953, the facility has been used by several diverse businesses.

This prospectus has three principal components: the first dealing with the history of the Sugar Creek Players; the second containing the goals; objectives and proposed uses of the theater, and the third containing the proposed budget for this project.

It should be noted that once the restoration project is complete, an Operations Board comprised of three Sugar Creek Players Board members will be responsible for the continuing operation and maintenance of the facilities for a two year term. Subsequent appointments will be made by the Sugar Creek Players Board President.

Donations for this project are anticipated from foundations, Montgomery County industries and business and professional offices and from individual establishments, small businesses and individuals.

I A HISTORY OF THE SUGAR CREEK PLAYERS

The Sugar Creek Players emerged as an embryo in the early spring of 1971 when the President of Wabash College and the Director of Theater decided that their lovely new building, the Humanities Center, should be shared with the community during the summer months. President Thad Seymour and Director Terry Ortwein talked to various interested members of the community and were met with enthusiasm at every turn. Soon a Board of Directors was formed and the business of producing the first season was under way.

The format for the first several years was basically this: a comedy to open the season and a musical show to close it, with various "imported" attractions in between. These interim attractions included such diverse programs as magic shows, old-time silent movies, Rudy Vallee and some visiting theater companies.

It soon became apparent that the home-talent programs were far more popular than the others, but the logistics problems connected with more local productions loomed large. The solution involved moving out of the Wabash Theater for many rehearsals and even some performances, and a high degree of coordination was required in scheduling.

The struggling Children's Theater--later to be called the Youth Theater--was taken into the Sugar Creek Players family and it has become a valued portion of our summer series. Later, the Sugar Creek Revue was added to the season, as it was a program that required a minimum of staging and group rehearsal time. Although the Revue began as a miscellaneous assortment of musical numbers and skits, it later became a scripted revue with a definite theme and format.

Although the Sugar Creek Players have always employed the services of a professional technical director, the players have striven to fill all other positions with volunteer help. It has become increasingly necessary to employ directors from outside the area, and this constitutes a major expense.

In the process of "growing up", Sugar Creek Players has cooperated with Wabash College in conducting a Teacher's Workshop two summers; the Players conducted an apprenticeship program for technical people for several summers, with excellent results for the organization as well as the individuals, and from time to time lectures and seminars have been sponsored. Sugar Creek Players has also sponsored, for some years, a Readers' Theater which was available for programs during the fall and winter months when stage productions were impossible. This group not only provided an opportunity for a number of individuals to participate, it proved to be a very successful publicity tool.

Looking back over the thirteen seasons of our existence much has been learned, a great deal has been accomplished and we firmly believe the best is yet to come.

SUGAR CREEK PLAYERS PAST PRODUCTIONS

| | | | |
|------|---|------|--|
| 1971 | Thurber Carnival You Can't Take it With You | 1982 | A 60's Revue I Do! I Do! Tom Sawyer |
| 1972 | The Boy Friend The Man Who Came to Dinner | 1983 | Hollywood Dinner Theatre A Thurber Carnival |
| 1973 | Carnival The Mousetrap Butterflies are Free The Roar of the Greasepaint Barefoot in the Park The Subject was Roses | 1984 | A Gershwin Revue The Ransom of Red Chief Telethon |
| 1974 | Our Town The Pajama Game Hay Fever You're a Good Man Charlie Brown | 1985 | Fantastics Dinner Theater Happy Days Telethon |
| 1975 | The Wonderful Tang The Male Animal L'il Abner | 1986 | Revue-Century of Song Saving Grace |
| 1976 | SCP Dinner Theater Revue Finishing Touches Anything Goes | 1987 | Revue-Can't Get Indiana Off My Mind |
| 1978 | SCP Revue 6 Rooms Riv Vu Bananas Annie Get you Gun | 1988 | Crimes of the Heart Revue-Showboat Cotton Patch Gospel Bob Redmon Magic Show Electric Dance- Snow White Ballet Youth Theatre- Christman Show |
| 1979 | Stage Door Canteen Revue The Hobbit Light Up the Sky Mame | | |
| 1980 | Richard Rodgers Revue Alice in Wonderland Harvey Gypsy | | |
| 1981 | A Cole Porter Revue Dr. Dolittle Chapter II Babes in Arms | | |

II SPECIFIC GOALS, OBJECTIVES AND PROPOSED USES FOR THE VANITY THEATER

To continue to stimulate and encourage (in the Montgomery County community) an active interest and participation in the performing arts.

To provide a flexible space, where none currently exists, in which to offer the Montgomery County community a season of diverse artistic endeavors.

To continue to offer an active production season, thereby making a cultural contribution to the community committed to arts, theater, and the enhancement of its cultural life and general economic picture.

To be capable of offering a year-round production season, rather than a limited "summer" season.

To be capable of providing an Educational Theater environment, such as an expanded "Youth Theater."

To enrich the lives of community residents through specially designed and supervised Educational Theater Workshops.

To sponsor Professional and Guest Artists programs incorporated into the annual production season.

To offer a viable Apprenticeship training program for interested students.

To cultivate a roster of talented individuals who are willing and able to serve as resources for producers, directors, musicians, technical directors, etc.

To provide an opportunity for the expression of new talent such as the sponsorship of playwriting contests for original works of theater.

To become the permanent home of the Sugar Creek Players including such functions as Production, Rehearsal Space, Board of Directors' Meetings, etc.

To become an "Arts" Center with the capacity to sponsor films, workshops, art and craft exhibits, musical recitals, etc.

To offer the use of the facility to civic, business and service organizations in the community as a meeting place for conferences, small conventions, seminars, etc.

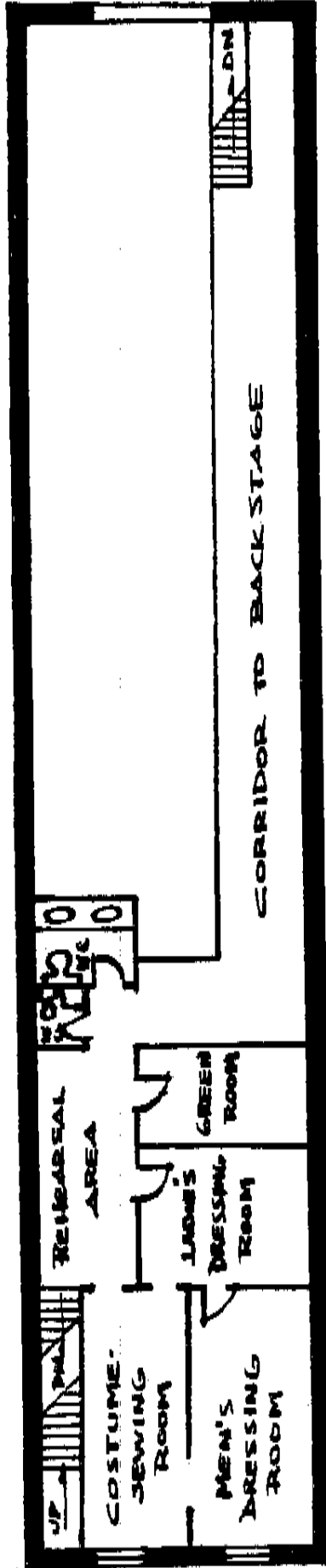
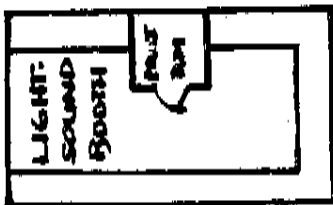

THE VANITY THEATRE
SECOND FLOOR PLAN

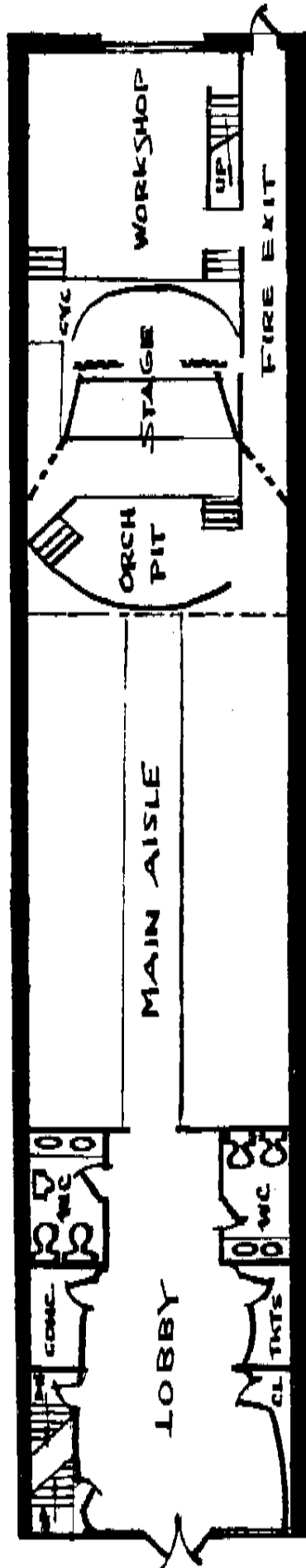

THE VANITY THEATRE
FIRST FLOOR PLAN

Seating Capacity 200

CRAWFORDSVILLE VANITY THEATRE
PURPOSED OPERATING BUDGET- FISCAL YEAR 1989

REVENUE

| | |
|-------------------------|---------------|
| Productions- admissions | 15,000. |
| Concession | 1,000. |
| Advertising | 1,600. |
| Corporate Sponsors | 3,000. |
| Bank Interest | 100. |
| Matching Grants- IAC | <u>4,000.</u> |
| Total | 24,700. |

EXPENSES

| | |
|----------------------|----------------|
| Utilities | |
| Water 325. | |
| Sewer-300. | |
| Gas 2000. | |
| Elec.1000. | 3625.00 |
| Insurance | 1350.00 |
| Production Cost | 11000.00 |
| Concessions | 1000.00 |
| Administration | 500.00 |
| Newsletter | 250.00 |
| Building Maintenance | 1000.00 |
| Ticket printing | 100.00 |
| Phone | 600.00 |
| Promotions | 1500.00 |
| Miscellaneous | 500.00 |
| Program Printing | <u>1600.00</u> |
| Total | 23025.00 |

1988- PROPOSED RENOVATION COST

Theatre--House

| | |
|------------------------|------------------|
| Heat and Air condition | \$35,000.00 |
| Wiring | 8,000.00 |
| Plumbing | 4,000.00 |
| Drywall | 2,000.00 |
| Paint | 500.00 |
| Labor | 10,000.00 |
| Sub-total | <u>59,500.00</u> |

Auditorium

| | |
|-----------|------------------|
| Carpet | \$ 9,000.00 |
| Seats | 14,000.00 |
| Sub-total | <u>23,000.00</u> |

Foyer

| | |
|--------|----------|
| Carpet | 2,000.00 |
|--------|----------|

Stage

| | |
|----------------------------------|-----------------|
| Lights: | |
| Fresnel \$90. ea. | 775.00 |
| Ellipsodal-- \$187.50 ea. | 1500.00 |
| Ground Cyc. 3 sec. \$325. 2 sets | 650.00 |
| White Scrim 24x16 | 775.00 |
| Dimmer Board and Control Panel | 4000.00 |
| Microphones | 500.00 |
| Stage flooring \$15. per sq. ft. | 7000.00 |
| Fly Gallery | 2000.00 |
| Blacks | 300.00 |
| Piano | 3000.00 |
| Sub-total | <u>20500.00</u> |

Dressing rooms

| | |
|--------------|----------------|
| Lights----- | 500.00 |
| Mirrors----- | 500.00 |
| Sub-total | <u>1000,00</u> |

Total 106,000.00

CRAWFORDSVILLE VANITY THEATRE

RENOVATION EXPENSES FOR JANUARY 1985 thru OCTOBER 1988

| | |
|------------------------|---------------|
| Architect | \$ 2206. |
| Permits | 601. |
| Joists | 943. |
| Knee Braces | 1512. |
| Elder Plumbing | 6642. |
| Sprinkler System | 17457. |
| Asbestos Removal | 1683. |
| Electrical-Rad Garrett | 5602. |
| Labor | 15042. |
| Materials | 9178. |
| Concrete | 421. |
| Drywall | 2817. |
| Electrical Wiring | 1460. |
| Fire Exit Door | 275. |
| Front Doors | 1051. |
| Insurance | 2876. |
| Utilities | 2228. |
| Trash Pickup | 216. |
| Printing | 1306. |
| Phone Deposit | 150. |
| Fund Raising Cost | 1502. |
| EQUIPMENT | |
| Theatre Lights | 900. |
| Used Sound Board | 1500. |
| TV Switcher | 121. |
| Headsets | 120. |
| Used Light Board | 600. |
| Total | <u>78409.</u> |

VANITY THEATER

PROPOSED SCHEDULE OF SHOWS FOR FISCAL YEAR- 1989

February 4-----ArtReach Touring Theatre- Rumpelstiltskin
and A Thousand Cranes - 3 performances

April-----SCP Revue- A Vaudeville Evening

May -----SCP -- Barefoot in the Park

June----- Youth Theatre

July -----SCP - Musical- Fiddler on the Roof

December----- A Christmas Show

Electric Dance - Ballet

Dates are still to be determined for the following productions:

Two visiting shows directed by Clara J. Marshall and Mark McCreary of Indianapolis.

Small Symphony Group with IAC providing half the funds.

One man show by Steve Moore.

Childrens Show

Through the Presenter Touring Program of IAC, we hope to bring other programs to Crawfordsville.

Other uses for the theatre

Workshops

Community Groups

Business Seminars

Beauty Pagents

Board of Directors

Jim Kochert--President

Bobbye Thompson---Vice-President

Jerily Holtson--Secretary

John Stenger--Treasurer

John Pea

Andrew Biddle

Lisa Cosby

Kurt Homann

Grace Kockert

Judy Oswalt

Phil Wray

Patsy Pattison

Marion Winter

Phyllis Fulford

Alan Homsher